

The MOTOMAN MPK2, MPK2F is a five-axis, high-speed robot that is particularly suitable in the following areas: order-picking, high-speed handling, picking-packing-palletizing and many other handling applications.

With its Wash-Down paintwork, the MPK2, MPK2F has been developed especially for use in the food industry and in environments with strict cleanliness requirements.

Thanks to its compact and streamlined design, the robot can operate even in confined workspaces.

The hollow-wrist design of the MPK2, MPK2F allows integrated supply lines for energy, fluids and air – all the way from the robot base to the tool.

This high-speed robot, with a payload of 2 kg, is characterized by its very high velocity and acceleration. With a maximum of 133 cycles/minute, this robot combines performance and reliability in all handling applications.

This all-round robot can be driven by the high-performance-controller DX100 as well as the compact-controller FS100.



Controlled by
DX100

Controlled by
FS100

Key benefits

- "Wash-down-painting" for maximum hygiene
- Minimal footprint
- Fast acceleration, high speed increase productivity
- Optional vision and conveyor tracking for maximum flexibility
- Mounting options: Floor, ceiling, wall to suit cell integration

MOTOMAN MPK2, MPK2F

Picking and packing





Allowable wrist load

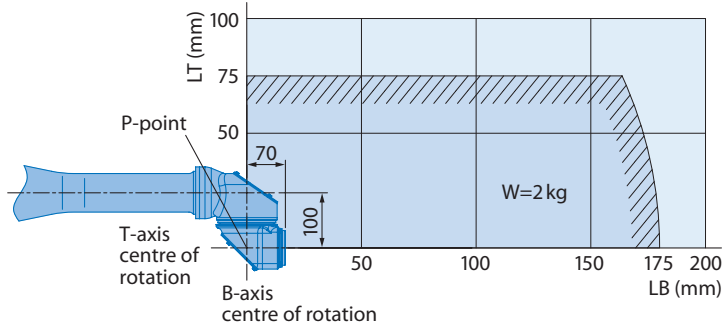

Specifications MPK2, MPK2F

Axes	Maximum motion range [°]	Maximum speed [°/sec.]	Allowable moment [Nm]	Allowable moment of inertia [kg · m ²]	Controlled axes	5
					Max. payload [kg]	2
					Repeat. pos. accuracy [mm]	±0.5
S	±170	320	–	–	Max. working range [mm]	R = 900
L	±120	330	–	–	Temperature [°C]	0 to +40
U	+282/–102	330	–	–	Humidity [%]	20 – 80
R	–	–	–	–	Weight [kg]	72
					Power supply, average [KVA]	2.0
B	±150	380	3.5	0.065	Optional Accessory: Wash Down Cover – Order Number 151915	
T	±270	2000	1.5	0.012		

View A

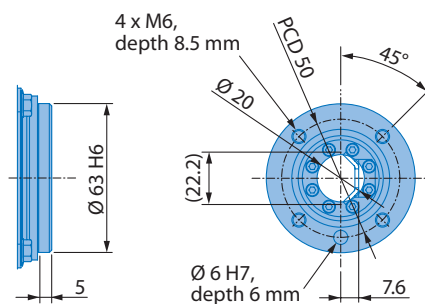

View B

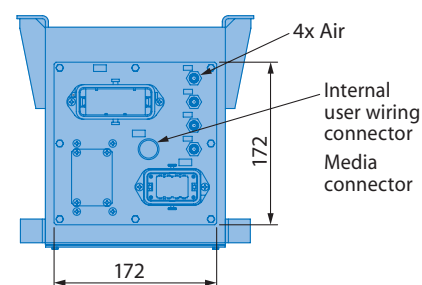

View C

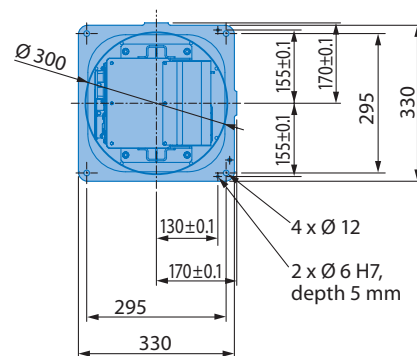

Mounting options: Floor, ceiling, wall

All dimensions in mm | Technical data may be subject to change without previous notice | Please request detailed drawings at robotics@yaskawa.eu.com – YR-MPK0002-B01 (DX100), YR-MPK002F-A00 (FS100), G-04-2014, A-No. 150304